

90° TUBE BENDS

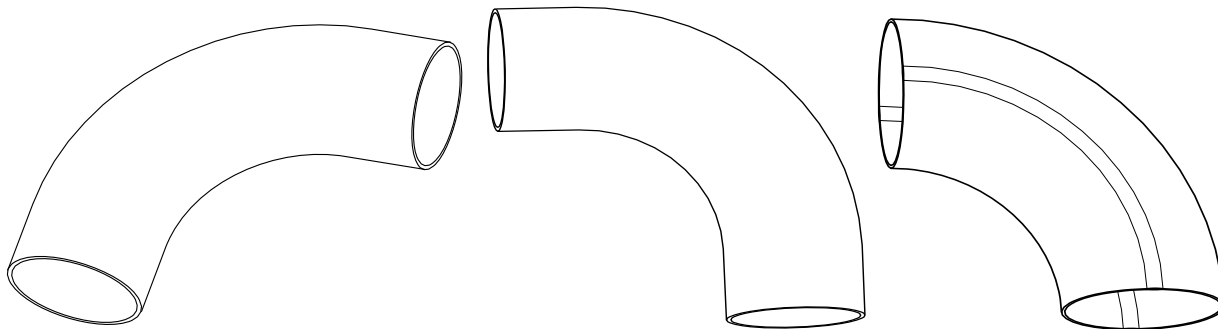

SIZE	***** 316 16# *****			***** 304 16# *****			316 14#	Pressed Bend 316 #14		2205 16#
	Unpol	Polish	Zetan Pol	Unpol	Polish	Zetan Pol	Polish	90° Unpol	45° Unpol	UNPOL
6mm	-	7.00	-	-	-	-	-	-	-	-
9mm	-	7.00	-	-	-	-	-	-	-	-
12mm	-	7.80	-	-	-	-	-	-	-	-
15mm	-	9.30	-	-	-	-	-	-	-	-
18mm	-	9.45	-	-	7.95	-	-	-	-	29.40
25mm	-	11.40	10.20	-	9.10	8.75	-	-	-	18.30
31mm	-	14.05	14.05	-	11.25	11.00	-	-	-	-
38mm	-	15.80	14.25	-	12.05	11.00	34.00	-	-	30.20
45mm	-	34.75	-	-	-	-	-	-	-	-
50mm	-	23.40	21.25	-	17.95	15.75	52.00	-	-	55.75
63mm	-	39.60	30.95	-	28.65	21.35	75.00	-	-	-
76mm	-	51.75	38.85	-	38.35	30.65	85.00	-	-	119.15 #14
89mm	-	51.50	-	-	-	-	-	-	-	152.70 #14
100mm	-	69.50	64.40	-	52.45	48.90	120.00	-	-	264.55 #14
125mm	152.30	156.00	-	-	-	-	-	-	-	-
150mm (14#)	219.55	223.25	-	163.20	166.90	-	-	-	-	-
200mm	200.00	-	-	-	-	-	-	-	-	-
250mm	-	-	-	-	-	-	-	455.00	320.00	-
300mm	-	-	-	-	-	-	-	685.00	480.00	-

(U90B6)
(P90B6)
(P90B6Z)
(U90B4)
(P90B4)
(P90B4Z)
(P90B14)
(BPB9)
(BPB4)
(B2205)

45° TUBE BENDS 316

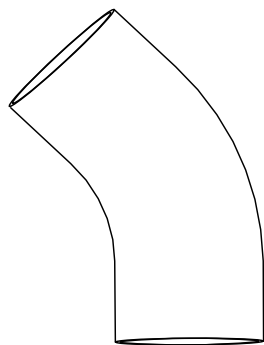

(U45B6 P45B6)

(150mm & 200mm in 14# wall)

SIZE	UNPOL	POL
12mm	-	7.20
18mm	-	8.25
25mm	-	10.45
31mm	-	12.70
38mm	-	14.35
45mm	-	32.60
50mm	-	21.50
63mm	-	29.10
76mm	-	40.55
89mm	-	45.05
100mm	-	62.55
125mm	133.65	137.35
150mm	192.15	195.85
200mm	140.00	-

45° TUBE BENDS 304

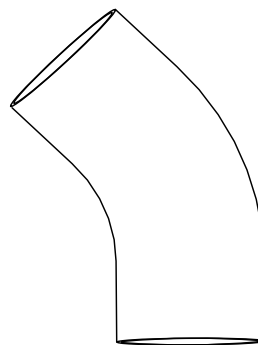

(U45B4 P45B4)

SIZE	UnPol	Pol
50mm	-	16.65
63mm	-	23.25
76mm	-	31.80
100mm	-	47.20
150mm	143.15	146.85

180° TUBE BENDS 316

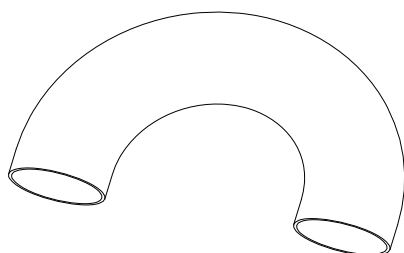

(U180B6 P180B6)

SIZE	Polished
18mm	18.70
25mm	22.70
31mm	27.00
38mm	33.20
45mm	83.75
50mm	52.55
63mm	73.75
76mm	101.85
100mm	161.65

90° TUBE BENDS 1x RADIUS (316)

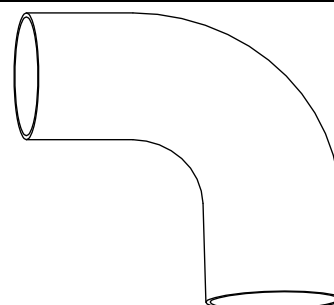

(B1R)

SIZE	PRICE
25mm	12.00
38mm	15.00
50mm	20.00
63mm	30.00
76mm	40.00
100mm	70.00