

## PLAIN CLAMP

(CLP)

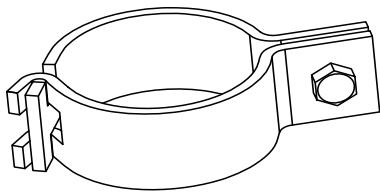

Material Grade: 304

SIZE	PRICE
18mm	7.00
25mm	6.00
31mm	7.00
38mm	6.50
50mm	7.50
63mm	9.00
76mm	10.00
100mm	12.00

## DOUBLE BOLTED CLAMP

(CLD)  
(CLDH)  
(CLDP)

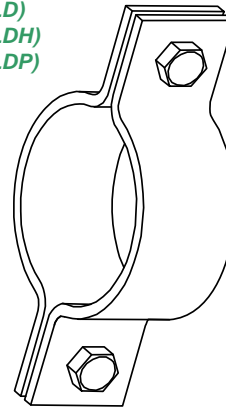

Material Grade: 304

SIZE	FOR TUBE	TUBE H/DTY	FOR PIPE
12mm	6.00	-	9.00
18mm	9.00	-	9.00
25mm	9.00	-	9.00
31mm	9.00	-	9.00
38mm	9.00	-	10.00
50mm	10.00	28.00	12.00
63mm	12.00	30.00	13.00
76mm	13.00	30.00	15.00
100mm	15.00	35.00	18.00
125mm	18.00	40.00	22.50
150mm	18.00	40.00	22.50
200mm	40.00	-	60.00
250mm	60.00	-	90.00
300mm	80.00	-	120.00

## TANG CLAMP

(CLT)

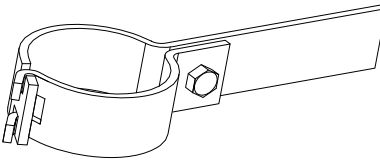

Material Grade: 304

SIZE	PRICE
18mm	7.50
25mm	6.50
31mm	7.50
38mm	7.00
50mm	8.50
63mm	10.00
76mm	11.00
100mm	13.00
*125mm	19.00
*150mm	19.00

\*Double bolted Only

## HOSE CLAMP

(CLHO)

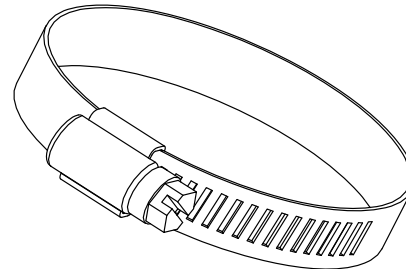

Material Grade: 304

SIZE	PRICE
12mm	3.60
18mm	3.60
25mm	3.60
31mm	3.60
38mm	3.60
50mm	4.00
63mm	4.80
76mm	4.80
100mm	5.20
125mm	10.80
150mm	10.80

## BOSSED CLAMP

(CLB)

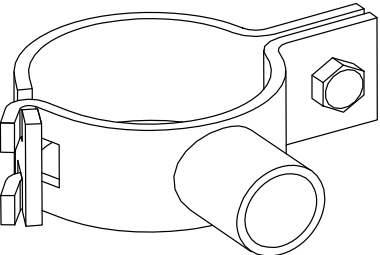

Material Grade: 304

SIZE	PRICE
18mm	10.00
25mm	9.00
31mm	10.00
38mm	9.50
50mm	10.50
63mm	12.50
76mm	13.50
100mm	15.00
*125mm	22.00
*150mm	22.00

\*Double bolted Only

## TUBE SADDLE

(CLS)

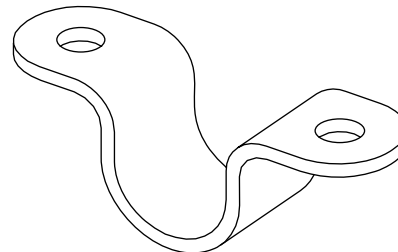

Material Grade: 304

SIZE	PRICE
6mm	1.40
9mm	1.50
12mm	1.90
18mm	3.25
25mm	3.50
31mm	4.25
38mm	4.50
50mm	5.00
63mm	6.00
76mm	7.00
100mm	8.00
125mm	20.00
150mm	20.00

## INTERLOCKING CLAMP

(CLI)

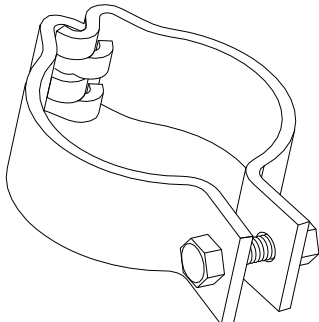

Material Grade: 304

SIZE	PRICE
18mm	6.00
25mm	6.50
31mm	7.50
38mm	7.00
50mm	8.00
63mm	9.50
76mm	10.50
100mm	12.50