

90° TUBE BENDS

(U90B6, P90B6, U90B4, P90B4, U90B14, P90B14, B2205)

(BPB9 BPB4)

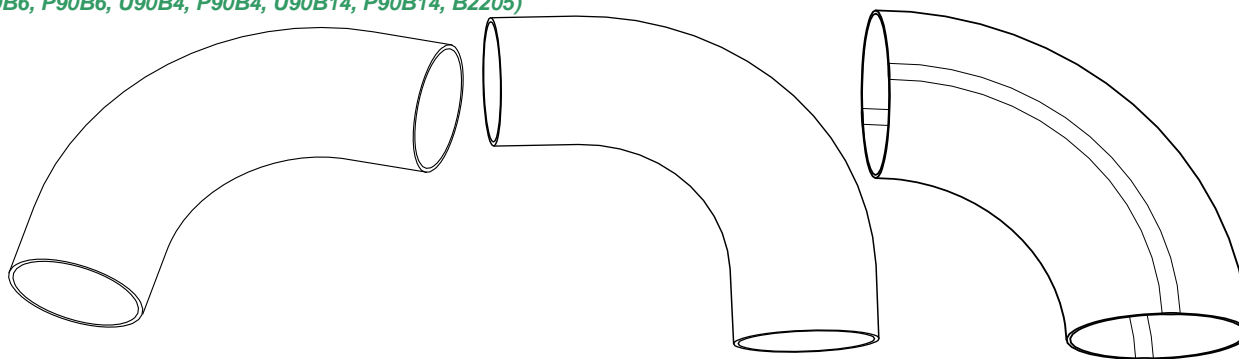

SIZE	316 16#		304 16#		316 14#		Pressed Bend 316 #14		2205 16#
	Unpolish	Polish	Unpolish	Polish	Unpolish	Polish	90° Unpol	45° Unpol	UNPOL
6mm	-	7.00	-	-	-	-	-	-	-
9mm	-	7.00	-	-	-	-	-	-	-
12mm	-	4.75	-	-	-	-	-	-	-
15mm	-	5.55	-	-	-	-	-	-	-
18mm	-	5.65	-	4.75	-	-	-	-	-
25mm	-	7.00	-	6.00	-	-	-	-	15.00
31mm	-	8.85	-	7.10	-	-	-	-	40.00
38mm	-	9.80	-	7.85	28.00	30.00	-	-	40.00
45mm	-	18.20	-	-	-	-	-	-	-
50mm	-	13.70	-	11.10	45.00	47.50	-	-	46.00
63mm	-	20.50	-	16.20	62.00	65.00	-	-	65.00
76mm	-	28.00	-	21.95	71.00	75.00	-	-	117.00
100mm	-	42.75	-	32.20	102.00	107.00	-	-	188.00
125mm	117.00	122.00	-	-	-	-	-	-	-
150mm	(14#) 121.00	129.00	(14#) 90.00	98.00	-	-	118.00	83.00	-
200mm	-	-	-	-	-	-	200.00	140.00	-
250mm	-	-	-	-	-	-	420.00	294.00	-
300mm	-	-	-	-	-	-	680.00	476.00	-

45° TUBE BENDS 316

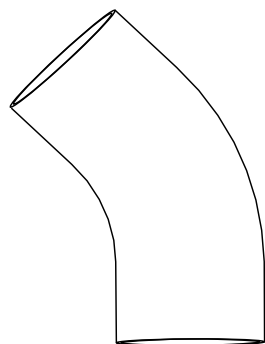

(U45B6 P45B6)

SIZE	UNPOL	POL
12mm	-	4.95
18mm	-	4.95
25mm	-	6.25
31mm	-	7.95
38mm	-	8.85
45mm	-	17.10
50mm	-	12.30
63mm	-	18.45
76mm	-	25.15
100mm	-	38.45
125mm	103.00	108.00
150mm	105.00	113.00

(150mm in 14# wall)

45° TUBE BENDS 304

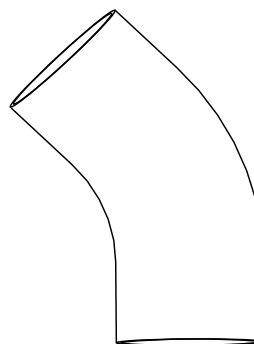

(U45B4 P45B4)

SIZE	Polished
50mm	9.95
63mm	14.60
76mm	19.75
100mm	29.00

180° TUBE BENDS 316

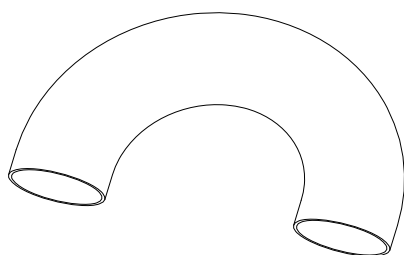

(U180B6 P180B6)

SIZE	Polished
18mm	13.70
25mm	13.70
31mm	16.95
38mm	20.20
45mm	42.80
50mm	29.75
63mm	45.80
76mm	62.55
100mm	96.30

90° TUBE BENDS 1x RADIUS (316)

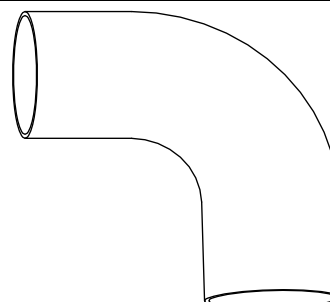

(B1R)

SIZE	PRICE
25mm	12.00
38mm	15.00
50mm	20.00
63mm	28.00
76mm	40.00
100mm	67.00